

LIFTER PIN SETS / LIFTER PINS

— RESIN TYPE —

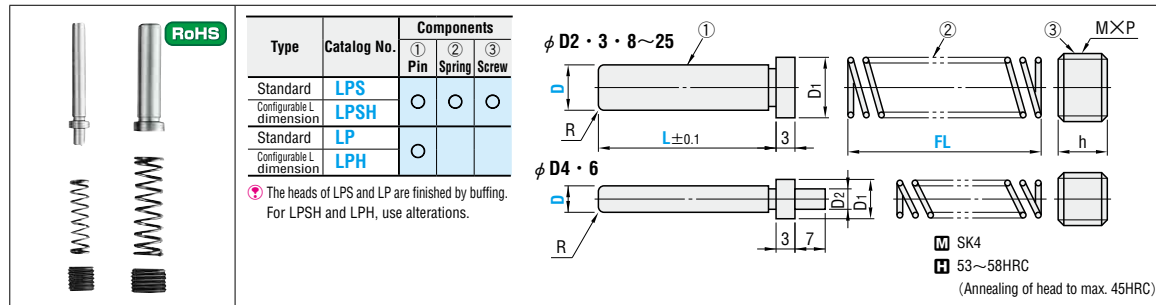

■ Standard type

① LP			③ MSW			Catalog No.		② SPRINGS														
D	D ₁	D ₂	R	M×P	h	Type	D	L														
2	3	—	0.3	4×0.7	4	LPS ①②③	2	10	15	20	25	28	30	33	35	36	40					
3	4	—	0.3	5×0.8	5		3	10	15	20	22	25	28	30	33	35	36	40				
4	6	3	—	8×1.25	8		4	10	15	20	22	25	28	30	33	35	36	40	45	50		
6	8	4.6	—	10×1.5	10		6	10	15	20	22	25	28	30	33	35	36	40	45	50	55	60
8	10	—	0.5	12×1.5	10		8	10	15	20	22	25	28	30	33	35	36	40	45	50	55	60
10	13	—	0.5	16×1.5	10		10	20	22	25	28	30	33	35	36	40	45	50	55	60		
13	16	—	—	20×1.5	12	LPH ①	13	20	22	25	28	30	33	35	36	40	45	50	55	60		
16	19	—	2.0	22×1.5	12		16	30	33	35	36	40	45	50	55	60	70					
20	23	—	—	27×1.5	12		20	30	33	35	36	40	45	50	55	60	70					
								20	30	33	35	36	40	45	50	55	60	70				

■ Configurable L dimension type

① LPH			③ MSW			Catalog No.		② SPRINGS			
D ₀₅	D ₁	D ₂	R	M×P	h	Type	D	L			
2	3	—	0.3	4×0.7	4	LPSH ①②③	2	10.0~ 40.0			
3	4	—	0.3	5×0.8	5		3	10.0~ 50.0			
4	6	3	—	8×1.25	8		4	10.0~ 50.0			
6	8	4.6	—	10×1.5	10		6	10.0~ 60.0			
8	10	—	0.5	12×1.5	10		8	10.0~ 80.0			
10	13	—	0.5	16×1.5	10		10	10.0~ 80.0			
13	16	—	—	20×1.5	12	LPH ①	13	20.0~ 90.0			
16	19	—	2.0	22×1.5	12		16	20.0~ 100.0			
20	23	—	—	27×1.5	12		20	25.0~ 100.0			
25	28	—	—	33×1.5	12		25	30.0~ 100.0			

Order **Catalog No.** — **L** — **②Type·FL**

LPS 10 — 30 — WH 50
 LP 8 — 28 —
 LPSH 13 — 35.0 — WM 60
 LPH 13 — 65.0

Days to Ship **Quotation**

Price **Quotation**

Alterations **Catalog No.** — **L** — **②Type·FL** — (SC, etc.)

LPSH 13 — 35.0 — WM60 — SC

Only alterations LPSH and LPH can be used.
 Express T and A cannot be used.

Alteration	Code	Spec.	1Code
	SC	Buffing of pin end	Quotation
	VSC	Lapping of pin end	
	RC	Spherical machining of pin end ⊗ Cannot be combined with VSC.	

Alteration	Code	Spec.	1Code
	YC	Taper machining of pin end YC: 0.1mm increments 0.3 ≤ YC ≤ D ₂ L _{min} ≤ L - YC X = D - 1.2 × YC ⊗ Cannot be used for D2-3. ⊗ Cannot be combined with RC.	Quotation
	SN	Elimination of the spring guide (D ₂ dimension) ⊕ Can be used for D4-6.	
	WA	Change of provided screw plug to MSWA (through hole type) ⊕ Can be used for LPSH D4~25 only. Detailed dimensions P.819	
	WZH	Change of provided screw plug to MSWZH (washer face type) ⊕ Can be used for LPSH D6~25 only. MSW MSWZH D6~10 h=10 → h=12 D13~25 h=12 → h=15 Detailed dimensions P.819	

② Coil springs For detailed specifications, refer to **P.1399**~.

D 3~D10 ... D₀-0.5
 D13~D27 ... D₀-0.8

RoHS

SWP-A

Spring constant table

① Pin		② Spring						
Catalog No.	Type	WR	WF	WL	WT	WM	WH	
LPS LPSH	2	N/mm 0.3 {0.03}	N/mm 0.5 {0.05}	N/mm 1.0 {0.1}	1.5(0.15)	2.0(0.2)	2.9(0.3)	
	3							
	4							
	6							
	8							
	10							
	13							
	16							
	20							
	25							

Maximum allowable deflection F_{max}. F=L×60% F=L×45% F=L×40% F=L×40% F=L×35% F=L×30%

● Load calculation method Load N (kgf) = Spring constant N/mm (kgf/mm) × Deflection Fmm ● Tolerance for spring constant: ±10%

Combinations of guide lifter pins and springs (○ indicates an available set.)

Type-D	LPS2-LPSH2					LPS3-LPSH3					LPS4-LPSH4					LPS6-LPSH6					LPS8-LPSH8										
	WR3	WF3	WL3	WT3	WM3	WR4	WF4	WL4	WT4	WM4	WR6	WF6	WL6	WT6	WM6	WR8	WF8	WL8	WT8	WM8	WR10	WF10	WL10	WT10	WM10	WR10	WF10	WL10	WT10	WM10	
20	○	○	○	○	○	○	○	○	○	○	○	○	○	○	○	○	○	○	○	○	○	○	○	○	○	○	○	○	○	○	○
25	○	○	○	○	○	○	○	○	○	○	○	○	○	○	○	○	○	○	○	○	○	○	○	○	○	○	○	○	○	○	○
30	○	○	○	○	○	○	○	○	○	○	○	○	○	○	○	○	○	○	○	○	○	○	○	○	○	○	○	○	○	○	○
35	○	○	○	○	○	○	○	○	○	○	○	○	○	○	○	○	○	○	○	○	○	○	○	○	○	○	○	○	○	○	○
40	○	○	○	○	○	○	○	○	○	○	○	○	○	○	○	○	○	○	○	○	○	○	○	○	○	○	○	○	○	○	○
45																															
50																															
55																															
60																															
65																															
70																															
80																															

* : Maximum allowable deflection F_{max}. is smaller than the above spring constant. For details **P.1399**~.

Lifter pins — Resin type —

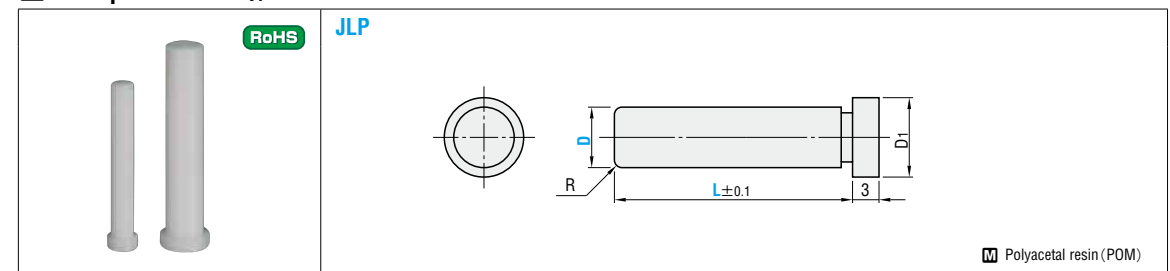

D	D ₁	R	Catalog No.		L	Base unit price
			Type	D	0.1mm increments	1~19 pieces
2	3	0.3	JLP	2	10.0~30.0	Quotation
3	4			3	10.0~30.0	
4	6			4	10.0~40.0	
6	8	6		10.0~50.0		
8	10	8		10.0~60.0		
10	13	10		10.0~60.0		

Order **Catalog No.** — **L**

JLP 3 — 15.5

Days to Ship **Quotation**

Price **Quotation**