

DATE MARKED PINS

— PL EXCHANGE TYPE / STANDARD • SHALLOW ARROW TYPE —

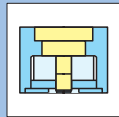

• The inside arrow can be replaced by the PL side (internal side of the die) without removing the plate.

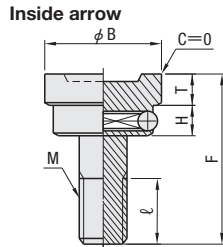

■ Inside arrow (For single items **P.109**)

No.	F	T	H	B	R	M×P
4				2.4		
5	7.7	1.5	3.0	2.9	2.7	M1.6×0.20
6				3.7		
8	9.7	2.0	3.5	5.0	3.2	M2.3×0.25
10	11.7		4.0	6.3	4.0	M2.5×0.35
12		2.5		7.5	4.2	M3.0×0.35
16	13.7			11.0	4.8	
20	15.7	3.5	5.0	13.2	5.3	M4.0×0.35

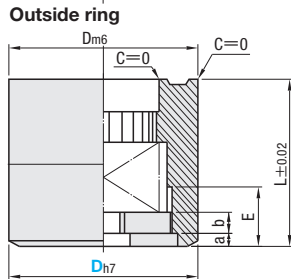

■ Outside ring (For single items **P.110**)

D	Dm6	Dh7	L	E	a	b
4	4	$+0.012$ $+0.004$	4	-0.012	2.8	
5	5	$+0.012$ $+0.004$	5	-0.012	8	2.85
6	6	$+0.012$ $+0.004$	6	-0.012	2.9	1.0
8	8	$+0.015$ $+0.006$	8	-0.015	10	3.4
10	10	$+0.015$ $+0.006$	10	-0.015	12	4.2
12	12	$+0.018$ $+0.007$	12	-0.018	14	4.4
16	16	$+0.018$ $+0.007$	16	-0.018	5.0	1.4
20	20	$+0.021$ $+0.008$	20	-0.021	16	1.5

⚠ Compared to the standard type, the inside arrow is difficult to turn, so be careful not to scrape the arrow with the tip of a screwdriver. If the inside arrow is scraped, it may not be possible to remove it.

■ SUS420F
■ 50~55HRC

■ Year · Month Type

Indication	Outside rings divisions	Part No.		Year	
		Type	D		
Year · Month 	12 uniform divisions	C—DTBX C—DTBXU (Shallow arrow)	4	20 For 2020	
			5		
			6		
			8		
			10		21 For 2021
			12		22 For 2022
			16		
20					

■ Month · Day · No-marking Type

Indication	Outside rings divisions	Part No.	
		Type	D
Month 	12 uniform divisions	C—DTD C—DTDU (Shallow arrow)	4
			5
			6
			8
			10
			12
Day (1st digit) 	12 uniform divisions	C—DTEX C—DTEXU (Shallow arrow)	4
			5
			6
	10 uniform divisions		8
			10
			12
Day (2nd digit) 	12 uniform divisions	C—DTFX C—DTFXU (Shallow arrow)	4
			5
			6
			8
			10
			12
No-marking 	12 uniform divisions	C—DTNX C—DTNXU (Shallow arrow)	4
			5
			6
			8
			10

■ Year Switching Type

Indication	Outside rings division	Part No.		Year	
		Type	D		
4 years type 	12 uniform divisions	C—DTX C—DTXU (Shallow arrow)	4	20 For 2020~2023	
			5		
			6		
			8		
			10		21 For 2021~2024
			12		22 For 2022~2025
16					
20					
6 years type 	12 uniform divisions	C—DTXS C—DTXSU (Shallow arrow)	4	20 For 2020~2025	
			5		
			6		
			8		
			10		21 For 2021~2026
			12		22 For 2022~2027
16					
20					



Order

Part No.	Year
(Year · Month) C—DTBX 16	20
(Year) C—DTX 6	20
(Month) C—DTDX 4	
(No-marking) C—DTNX 8	



Days to Ship

10 Days



Price

Order / Quote:
WOS: <https://in.misumi-ec.com/>
TEL: +91-124-468-8800 E-mail: cs@misumi.co.in