

# STEEL COUPLINGS

-STANDARD TYPE (HEAT RESISTANCE 60°C)-

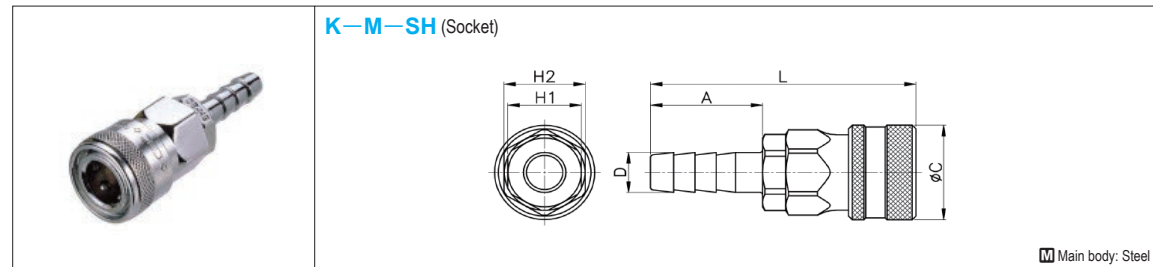

**K-M-SH** (Socket)

Main body: Steel

Max. pressure MPa (kgf/cm <sup>2</sup> )	Usable temp. range	φ C	D	L	A	H1 (Hex)	H2 (Hex)	Part Number		Unit Price
								Type	No.	
0.99 (9.9)	32~140°F/ 0~60°C	26	9	67.5	27	19	21	<b>K-M-SH</b>	20	<b>Quotation</b>
			11	69.5	29				30	
			14.5	73.5	33				40	

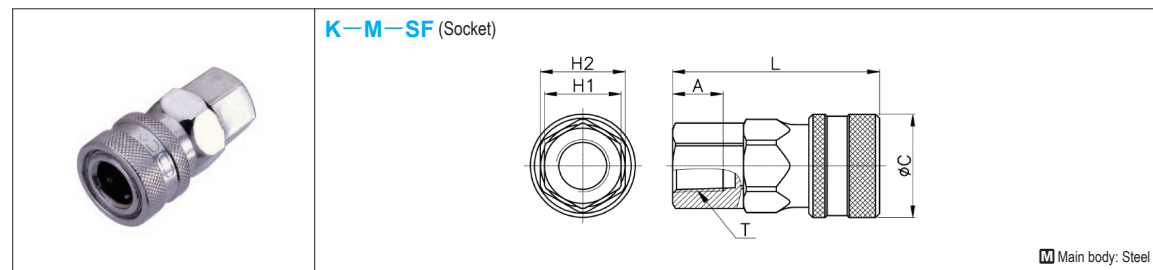

**K-M-SF** (Socket)

Main body: Steel

Max. pressure MPa (kgf/cm <sup>2</sup> )	Usable temp. range	φ C	T	L	A	H1 (Hex)	H2 (Hex)	Part Number		Unit Price
								Type	No.	
0.99 (9.9)	32~140°F/ 0~60°C	26	Rc 1/4	52	15.5	19	21	<b>K-M-SF</b>	20	<b>Quotation</b>
			Rc 3/8	52.5	14	21	21		30	
			Rc 1/2	54.5	17	25	21		40	

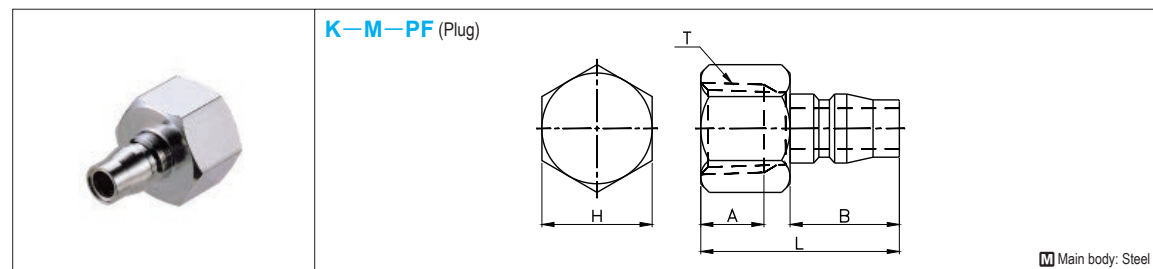

**K-M-PF** (Plug)

Main body: Steel

Max. pressure MPa (kgf/cm <sup>2</sup> )	Usable temp. range	T	L	A	B	H	Part Number		Unit Price
							Type	No.	
0.99 (9.9)	32~140°F/ 0~60°C	Rc 1/4	36.5	13.5	20.5	17	<b>K-M-PF</b>	20	<b>Quotation</b>
		Rc 3/8	39	14.5		21		30	
		Rc 1/2	40.5	15.5		25		40	



Order

Part Number

- K-M-SH30
- K-M-SF30
- K-M-PF30



Days to Ship

**Quotation**



Price

**Quotation**

# BRASS COUPLINGS

-(HEAT RESISTANCE 80°C)-

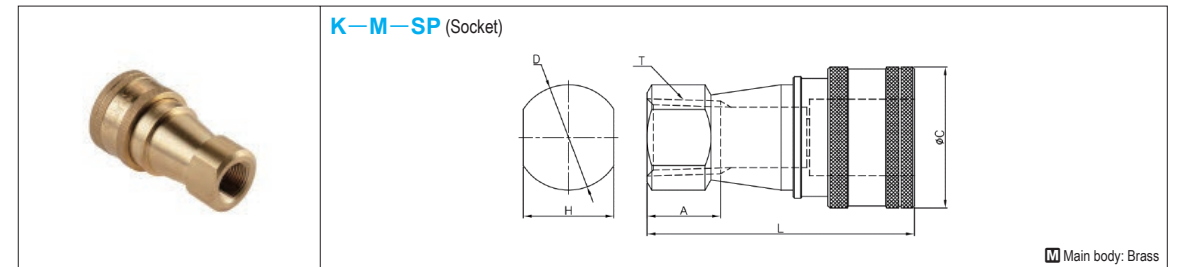

**K-M-SP** (Socket)

Main body: Brass

Max. pressure MPa (kgf/cm <sup>2</sup> )	Usable temp. range	φ C	T	L	A	H1 (Hex)	D	Part Number		Unit Price
								Type	No.	
5.0 (50)	-20°C~+80°C		Rc 1/8	47.9	8.5	14	18	<b>K-M-SP</b>	01S	<b>Quotation</b>
			Rc 1/4	58.2	11	19	22		02S	
			Rc 3/8	64.9	12	22	26		03S	
3.0 (30)			Rc 1/2	75	15	27	32	04S	<b>Quotation</b>	
			Rc 3/4	90.4	16	33	40	06S		

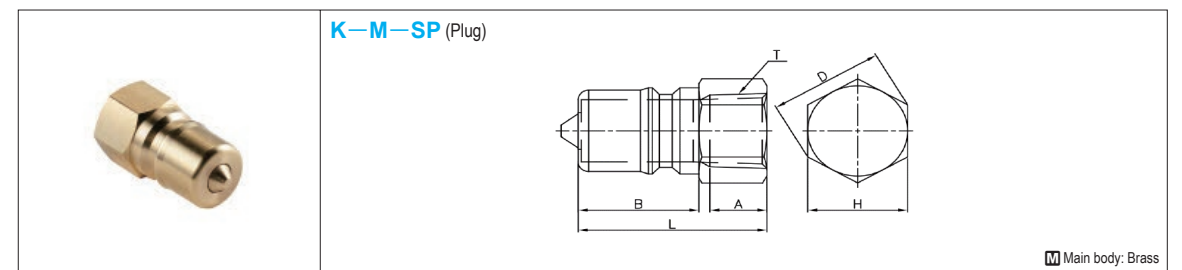

**K-M-SP** (Plug)

Main body: Brass

Max. pressure MPa (kgf/cm <sup>2</sup> )	Usable temp. range	T	L	B	H	H (Hex)	D	Part Number		Unit Price
								Type	No.	
5.0 (50)	-20°C~+80°C	Rc 1/8	28.7	19	8.5	14	16.2	<b>K-M-SP</b>	01P	<b>Quotation</b>
		Rc 1/4	36	22	11	17	19.7		02P	
		Rc 3/8	39.7	25.4	12	21	24.3		03P	
3.0 (30)		Rc 1/2	46.5	28.1	15	27	31.2	04P	<b>Quotation</b>	
		Rc 3/4	54.2	36.2	16	35	40.5	06P		



Order

Part Number

- K-M-SP01S
- K-M-SP01P



Days to Ship

**Quotation**



Price

**Quotation**