

Slide Door Units

Aluminum Extrusions for Slide Doors / Slide Rails / Mounting Plates / Slide Spacers

HRUA

<Product Image>

This product requires assembly.

<Extrusions when HRUA5 selected>

<Extrusions when HRUA6 selected>

HRUB

<Product Image>

This product requires assembly.

<Extrusions when HRUB5 selected>

<Extrusions when HRUB6 selected>

Part Number	Type	No.	Panel Selection (Select a desired material and thickness from the codes below.)		W (Width) 1mm Increment	H (Height) 1mm Increment	A Opening Dimensions	Components							
			AC (Thickness 5mm)	PC (Thickness 5mm)				PY (Thickness 5mm)	ST (Thickness 5mm)	Extrusion A	Extrusion B	Fastening Parts	Slide Spacers	Handle	
HRUA	5	6	AC (Clear)	PC (Clear)	500-2000	300-900	W/2-56.5	HFSS-2020	HFHRF5-2020	SCB5-25	4	HRLSP	2	HHDS90	2
	6	6	PET (Clear)	Anti-static PVC (Clear)	500-1900	300-900	W/2-36.5	HFS6-3030	HFHRF6-3030	SCB8-40	-	HRLSP	2	HHDS90	2

Ordering Example: Part Number - Panel - W - H
 HRUA6 - AC - 1200 - 750

Part Number	W(mm)	H/Height (mm)		Panel Selection	Material Multiplier
		300-599	600-900		
HRUA	5	500-999		AC	x1.0
		1000-1499		PC	x1.3
	6	500-999		PY	x0.9
		1000-1499		ST	x1.3

Assembly Example of HRUB

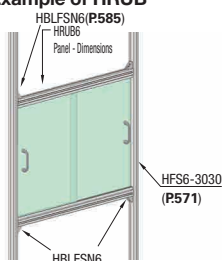

Assembly Example of HRUA6

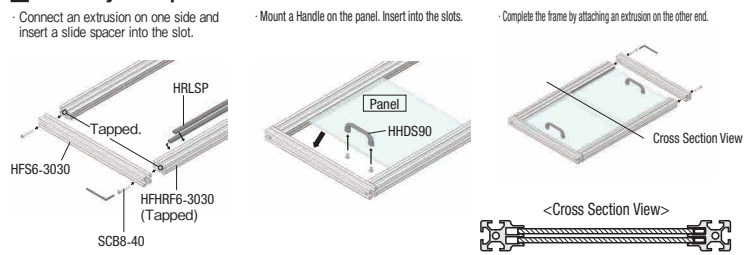

Aluminum Extrusions for Slide Doors

HFHRF5-2020

HFHRF6-3030

HFHRT6-3030

Applicable to panels of 5mm thickness.
 Material: A6N01SS-T5
 Surface Treatment: Anodize

Slide Rails

HRLFL

Applicable to panels of 5mm thickness.
 Material: A6N01SS-T5
 Surface Treatment: Anodize

Mounting Plates

HRLPL6
HRLPL8

Material: SPCC
 Surface Treatment: Bright Chromate Plating

Slide Spacers

HRLSP

(To be inserted into Slide Rail's two bottom rows (three bottom rows))

Type: HRLSP
 Material: Polyethylene (Black)
 Heat Resistant Temperature: -45 ~ 80°C

Aluminum Extrusions for Slide Doors

Part Number	L 0.5mm Increment	Mass kg/m	Sectional Area mm ²	Cross Sectional Moment of Inertia mm ⁴	Unit Price Less than 300mm	Unit Price/m 300mm or more
HFHRF5-2020	50-4000	0.83	308	3.16x10 ⁴	1.25x10 ⁴	
HFHRF6-3030		1.43	528	7.18x10 ⁴	4.13x10 ⁴	
HFHRT6-3030		1.43	529	8.11x10 ⁴	4.62x10 ⁴	

Mounting Plates

Part Number	Type	Applicable Extrusion (Series)	Accessory			Unit Price 1 ~ 4 pc(s)	Volume Discount Rate 5-120
			Screw	Quantity	Nut		
HRLPL	6	HFS6	CBM6-10	2	HNTT6-6	2	
	8	HFS8	CBM6-10	1	HNTT6-6	1	

*Screws and Nuts for mounting on extrusions.

Ordering Example: Part Number - L
 HFHRF6-3030 - 1200
 HRLFL - 300
 HRLSP - 300

Slide Rails

Part Number	W (Width) 1mm Increment	Applicable Extrusion (Series)	Mass kg/m	Sectional Area mm ²	Unit Price/m
HRLFL	50-3000	HFS6 HFS8 HFS8-45	0.716	265	

Slide Spacers

Part Number	Length mm	Unit Price 1 ~ 4 pc(s)	Volume Discount Rate 5-50	Part Number	Length mm	Unit Price (set of 30 pcs.)
HRLSP	2000			HRLSP-SET	2000	

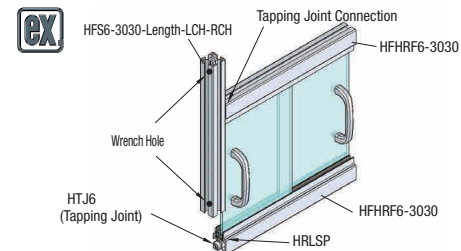

Alterations: Part Number - L - (Alteration Code)
 HFHRF6-3030 - 1500 - TPW

Alterations Code	Tapping (Applicable to HFTF5-2020, NFTF5-2020, HFTF6-3030, NFTF6-3030)		
	LTP	RTP	TPW
Spec.	Tapping on the Left End Face	Tapping on the Right End Face	Tapping on Both Ends
Type	HFHRF5-2020	HFHRF6-3030	HFHRT6-3030
Tap Shape	M5-Depth15	M8-Depth24	M8-Depth24

<When HFHRF / HFHRT used>

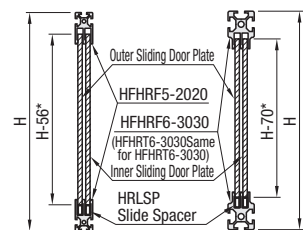

HFHRF5 * When H dimension is less than 318, design with H-60.
 HFHRF6, HFHRT6 * When H dimension is less than 325, design with H-74.

<When HRLFL used>

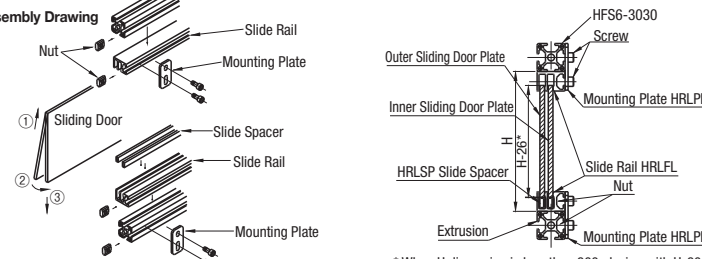

* When H dimension is less than 300, design with H-30.