

Roll Brush

Channel Roll Brush, Tight Rolled, Pitch Configurable

■ Pipe core type roll brush for general purpose applications are provided with 5th day shipping.

■ Tight Rolledes

Type	Brush Filament	Pipe, Bushing, Connecting Part
BRUSNR	Nylon 6	SUS304

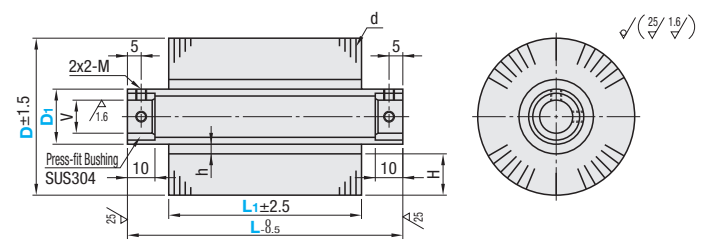
RoHS10

■ Tight Rolled

Part Number Type	D1	D Selection	L Selection	L1 5mm Increment	V	h	d	H	M	Proper Motor Power (Unit: kW) Reference Value	I.D. Tolerance (Bushings)	
											L	V
BRUSNR	20	50	100	20-320	12	3.5	0.21	11.5	4	0.4	100	H9
		60										
		80										
		100										
		120										
	30	70	250	L1≤L-30	20	5.5	0.295	14.5	5	0.4	150	H9
		80										
		100										
		120										
		150										

Ordering Example: Part Number - D - L - L1
BRUSNR20 - 80 - 150 - 100

Part Number Type	D1	D Selection	L Selection	Unit Price L1 (5mm Increment)														
				20-100	105-150	155-200	205-250	255-300	305-320									
BRUSNR	20	50	100							30	70	100						
		60																
		80																
		100																
		120																
	20	50	150							30	70	150						
		60																
		80																
		100																
		120																
	20	50	250							30	70	250						
		60																
		80																
		100																
		120																
20	50	350							30	70	350							
	60																	
	80																	
	100																	
	120																	

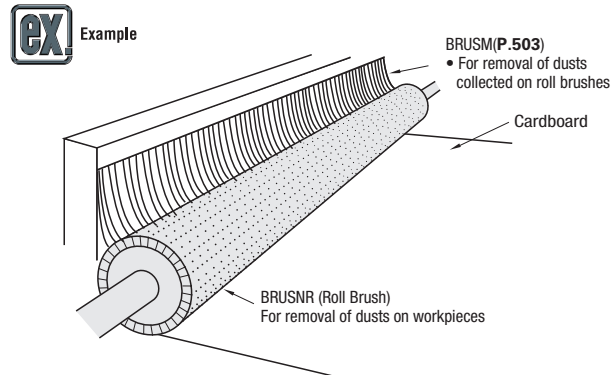

Alterations Part Number - D - L - L1 - DC
BRUSNR20 - 80 - 150 - 100 - DC75

Alterations	Brush Trimming	
	Changes brush O.D.	
Code	DC	
Spec.	5mm Increment, Ordering Code DC85	
	D1	DC (5mm Increment)
	20	55-95
30	75-115	

■ Pitch configurable roll brush to minimize the clogging.

■ Pitch Configurable

Type	Brush Filament	Pipe, Bushing, Connecting Part
BRUSNP	Nylon 6	SUS304

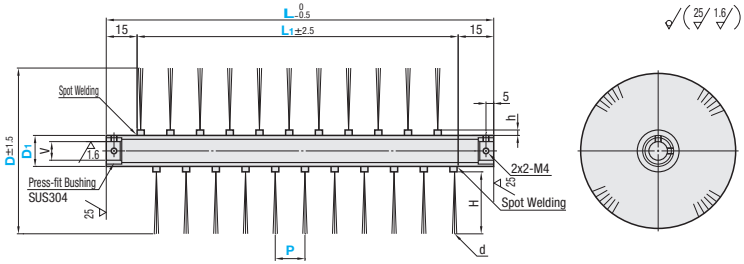
RoHS10

⚠ L1 dimensions have priority, thus P dimensions on the both sides may not be ensured.

■ Pitch Configurable

Part Number Type	D1	D Selection	L Selection	L1 5mm Increment	P Selection	V	h	d	H	M	Proper Motor Power (Unit: kW) Reference Value	I.D. Tolerance (Bushings)	
												L	V
BRUSNP	20	50	100	20-320	L1≤L-30	12	5.5	0.3	13.5	4	0.4	100	H9
		60											
		80											
		100											
		150											
20	200	250	40	12	5.5	0.3	23.5	4	0.75	150	+0.1/0		
	250												
	350												

Ordering Example: Part Number - D - L - L1 - P
BRUSNP20 - 60 - 250 - 200 - 20

Part Number Type	D1	D Selection	L Selection	Unit Price L1 (5mm Increment)														
				20-100	105-150	155-200	205-250	255-300	305-320									
BRUSNP	20	50	100							30	70	100						
		60																
		80																
		100																
		120																
	20	50	150							30	70	150						
		60																
		80																
		100																
		120																
	20	50	250							30	70	250						
		60																
		80																
		100																
		120																
20	50	350							30	70	350							
	60																	
	80																	
	100																	
	120																	

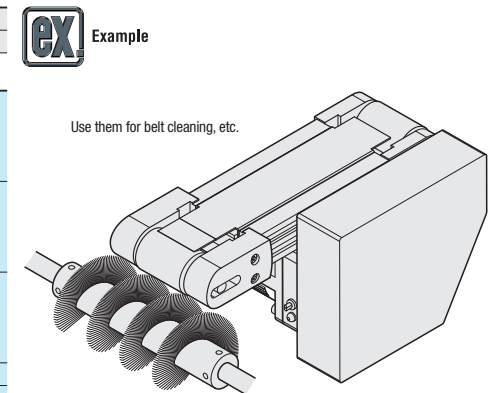

- Precaution for Use**
- Brush's service life will vary depending on usage conditions and frequency. The filaments may break or fall out depending on usage condition. Do not unduly tug the filaments or disassemble the brush.
 - Maximum temp. limit for the filaments is 100°C. The filaments will melt and fall off at above that.
 - Nylon 6 dissolves in strong hydrochloric acid, sulfuric acid, formic acid, and phenolic acid.
 - Brush press contact length should be 2mm or less. Do not press further than necessary.
 - Use the brush at less than 1000rpm.
 - Motor power values shown are experimental ones for reference only. Actual motor power needed may be larger depending on how the brush is used.

- Precaution for Use and Storage**
- Beware of the deformation of the filaments in storage. If the brush is left in contact with workpiece while in storage, the filaments may be deformed permanently. Also avoid filament tips from contacts when storing brushes by themselves.
 - Dry before storage.
 - Remove any foreign objects from the brush.
 - Do not use in high temp. environment or near fire.

Alterations Part Number - D - L - L1 - DC
BRUSNP20 - 80 - 150 - 100 - DC55

Alterations	Brush Trimming	
	Changes brush O.D.	
Code	DC	
Spec.	5mm Increment, Ordering Code DC85	
	D1	DC (5mm Increment)
	20	55-95