

# Configurable Length Screws with Hex Sockets

Tip Shape Selectable

## Configurable Length Screws with Hex Sockets Tip Shape Selectable



Type	Material	Surface Treatment	Pad
FSSF FSST FSSC FSSG	S45C	Black Oxide	-
FSSM	SCM435	Black Oxide Coating	White Polyacetal
FSSU	SCM435	Free-cutting Brass (C3604BD)	-
FSSFS FSSTS FSSGS	SUS304	-	-
FSSMS	Equivalent	-	White Polyacetal
FSSUS	Equivalent	-	Free-cutting Brass (C3604BD)

**FSSF** (Flat End)  
**FSSFS** (Flat End, Stainless Steel)

**FSST** (Cone Point)  
**FSSTS** (Cone Point, Stainless Steel)

**FSSC** (Cup Point)

**FSSG** (Dog Point)  
**FSSGS** (Dog Point, Stainless Steel)

**FSSM** **FSSMS** (Plastic Pad)  
**FSSU** **FSSUS** (Brass Pad)

\* FSST / FSSTS (Cone Point) M=L size is 60°.

Part Number	Type	M	L 1mm Increment	B	C (Min.)	d (Max.)					S (with Plastic / Brass Pad)	b (Dog Point)
						Flat End	Cone Point	Cup Point	Dog Point	with Plastic / Brass Pad		
FSSF	(Flat End)	5	20~250	2.5	3	3.5	1.25	2.5	4	3	1	4
FSSFS	(Flat End, Stainless Steel)	6		3.0	3.5	4.0	1.5	3	4	4	1	4
FSST	(Cone Point)	8	20~400	4.0	5	5.5	2.0	5	6	5	2	5
FSSTS	(Cone Point, Stainless Steel)			5.0	6	7	2.5	6	8	6	6	2
FSSC	(Cup Point)	10	6.0	8	8.5	3	8	8	8	2	7	
FSSG	(Dog Point)	12	20~400	8.0	10	12	4	10	10	10	3	9
FSSGS	(Dog Point, Stainless Steel)			10.0	12	15	5	14	12	13	3	11
FSSM FSSMS	(Plastic Pad)	16	20~400	8.0	10	12	4	10	10	10	3	9
FSSU FSSUS	(Brass Pad)			10.0	12	15	5	14	12	13	3	11

Ordering Example: Part Number - L  
FSS6 - 100

M	L	FSSF	FSST	FSSC	FSSG	FSSM	FSSU	FSSFS	FSSTS	FSSGS	FSSMS	FSSUS
5	20~100											
	101~200											
	201~250											
6	20~100											
	101~200											
	201~250											
8	20~100											
	101~200											
	201~400											
10	20~100											
	101~200											
	201~400											
12	20~100											
	101~200											
	201~400											
16	20~100											
	101~200											
	201~400											
20	20~100											
	101~200											
	201~400											

Alterations Example: Part Number - L - (SKH)  
FSS6 - 100 - SKH

Alteration Code	Tip Induction Hardened
SKH	Induction hardening at 2 ~ 3mm away from the tip. Hardness: 40 ~ 45HRC Ordering Code SKH
	Applicable only to FSSF, FSST and FSSG.

# Hexagon Socket Screws - Dog Point

Hex Socket Set Screws / Hex Socket Head Cap Screws Standard and Configurable

## Hexagon Socket Screws - Dog Point



### MSSG (Hex Socket Set Screws)

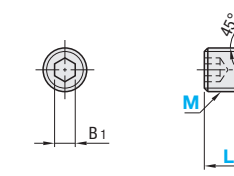

These differ from JIS dog point set screws in dimension of nose portion.  
Use for rough locking of shafts, etc. where continuous load is not imparted to the nose portion.

### CBBG (Hex Socket Head Cap Screws, Stainless Steel)

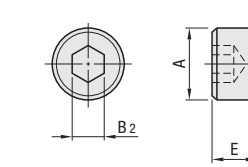

These differ from JIS dog point set screws in dimension of nose portion.  
Use for rough locking of shafts, etc. where continuous load is not imparted to the nose portion.

Part Number	Type	M (Coarse)	L					B1	B2	A	E	d		b	C	R	Unit Price		
			FMSSG	FMSSGS	FCBBG	FCBBGS	Reference Dim.					Tolerance	FMSSG				FMSSGS	FCBBG	FCBBGS
MSSG CBBG CBBGS		4	12	16	20	25	30	2	3	7	4	3	-0.1	3	0.3	0.5			
		5	12	16	20	25	30	2.5	4	8.5	5	4	-0.2	4					
		6	12	16	20	25	30	35	40	3	5	10	6						
		8	16	20	25	30	35	40	45	4	6	13	8	6	-0.1	5			
		10	20	25	30	35	40	45	50	5	8	16	10	8	-0.3	6			

## Hexagon Socket Screws - Dog Point Configurable



### FMSSG (Hex Socket Set Screws)

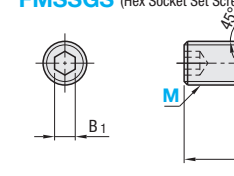

Use for rough locking of shafts, etc. where continuous load is not imparted to the nose portion.

### FCBBG (Hex Socket Head Cap Screws, Stainless Steel)

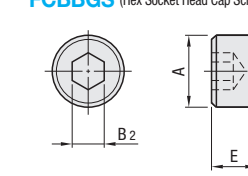

Use for rough locking of shafts, etc. where continuous load is not imparted to the nose portion.

Part Number	Type	M (Coarse)	L 1mm Increment			F 1mm Increment	B1	B2	A	E	d		b	C	R	Unit Price				
			FMSSG	FMSSGS	FCBBG						FCBBGS	Reference Dim.				Tolerance	FMSSG	FMSSGS	FCBBG	FCBBGS
FMSSG FMSSGS FCBBG FCBBGS		4	-	-	12-25	2-30 10sL-F	-	3	7	4	3	-0.1	3	0.3	0.5					
		5	12-25	-	12-25		2.5	4	8.5	5	4	-0.2	4							
		6	12-40	-	12-30		3	5	10	6										
		8	12-50	-	12-35		4	6	13	8	6	-0.1	5							
		10	12-50	-	12-40		5	8	16	10	8	-0.3	6							

Ordering Example: Part Number - L - F  
FMSSG5 - 16  
FMSSG6 - 50 - 20

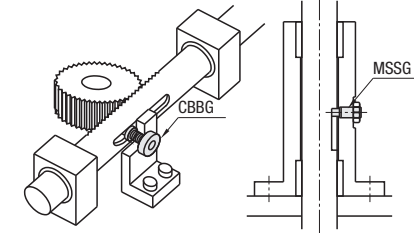

Alterations Example: Part Number - L - (RC, RS)  
CBBG8 - 20 - RS

Alterations	Tip R Machining				Undercut			
	M	R	b	F	M	f	g	r
Code	RC				RS			
Spec.	Adds Tip R Processing to the tip of a nose portion. Not applicable to CBBGS. Ordering Code RC				Adds an undercut below the head of Head Cap Screws. Applicable only to CBBG, FCBBG and FCBBGS. Ordering Code RS			
	4	3	3		4	3.2	1.5	0.2~0.3
	5	4	4		5	4.1		
	6	4	4		6	4.9	2	
	8	6	5		8	6.6		
	10	8	6		10	8.3	2.5	0.2~0.5

Alterations only to FCBBG, FCBBGS. Can be used in combination with RC and RS.