

Post (Hex, Square and Circular)

Overview

Small Dia. Hex Posts

Both Ends Tapped / One End Threaded One End Tapped

Misumi Round Pole Lineups

For posts, see the following:

Product Name	Posts (for post use)
App. Example	
Page	P2115
Shaft Dia. Tolerance	0 -0.1
Material / Hardness	SS400/Steel for General Structure: SUS304

For materials, see the following:

Product Name	Round Bars (Material)
App. Example	
Shaft Dia. Tolerance	0 -0.1 0 -0.2 ±0.1-0.4
Material / Hardness	SUS/Aluminum/Carbon Steel/Chromium Molybdenum Steel/Copper

For rotational use, see the following:

Product Name	Rotary Shaft (For Rotation)
App. Example	
Shaft Dia. Tolerance	h7 / g6 / h9
Material / Hardness	S45C SUS304

For linear motion use, see the following:

Product Name	Shaft (For Linear Motion use)
App. Example	
Shaft Dia. Tolerance	g6 / f8 / h5
Material / Hardness	SIUJ Equivalent, SBRHC-S45C or SUS304, SUS440C Equivalent S5PRC-

Shape and Material Selection List

Shape Name, Type	Shape	Hex Posts						Page	Circular Posts						Page		
		Steel (SS400/Steel for general structure*)		Stainless Steel (SUS303, 304)	Aluminum (A2011)	Steel (SS400/Steel for general structure)			Stainless Steel (SUS304)	Aluminum (A2017)	Plastic (Polyacetal)	Page					
		No Surface Treatment	Black Oxide	Electroless Nickel Plating	Trivalent Chromate	No Surface Treatment	Clear Anodize		No Surface Treatment	Black Oxide	Electroless Nickel Plating		Trivalent Chromate	No Surface Treatment		Clear Anodize	
Both Ends Tapped	Small Dia.	-	●	●	-	●	-	P2116	-	-	-	-	-	-	-	-	P2127 P2136
	Standard	●	●	●	●	●	●	P2117	●	●	●	●	●	●	●	●	
One End Threaded One End Tapped	Small Dia.	-	●	●	-	●	-	P2116	-	-	-	-	-	-	-	-	P2129 P2131
	Standard	●	●	●	●	●	-	P2119 P2121	●	●	●	●	●	-	-	-	
Both Ends Threaded	Standard	●	●	●	-	●	-	P2121	●	●	●	-	-	-	-	-	P2131
	Standard	●	●	●	-	●	-	P2121	●	●	●	-	-	-	-	-	
Pilot	Both Ends Tapped	●	●	●	-	●	-	P2123	●	●	●	-	●	-	-	-	P2133
	One End Threaded One End Tapped	●	●	●	-	●	-	P2123	●	●	●	-	●	-	-	-	
	Both Ends Threaded	●	●	●	-	●	-	P2123	●	●	●	-	●	-	-	-	
One End Tapped	Standard	●	●	●	-	●	-	P2125	●	●	●	-	●	-	●	-	P2135 P2136
	Standard	●	●	●	-	●	-	P2125	●	●	●	-	●	-	-	-	

*Small diameter hex posts (only) are partly SUM43.

Shape Name, Type	Shape	Square Post				Page
		Steel (SS400/Steel for general structure)		Stainless Steel (SUS304)	Page	
		No Surface Treatment	Black Oxide	Electroless Nickel Plating		
Square Post	Both Ends Tapped	●	●	●	●	P2137
	One End Threaded One End Tapped	●	●	●	●	P2137

Relief Dimension of Threaded Post (Reference)

	M	MC	g
	2	1.5	
	2.6	2.1	0.8
	3	2.4	1.0
	4	3.2	1.2
	5	4.1	1.5
	6	4.4	2.0
	8	6	3.0
	10	7.7	3.0
	12	9.4	
	16	13	4.0
	20	16.4	
	24	19.6	5.0
	27	23	
	30	25	

Features: Suitable when space is limited.

Small Dia. Hex Posts



Type		Material	Surface Treatment
Both Ends Tapped	One End Threaded One End Tapped		
BSLCB	BSLCG	Steel for general construction or SUM	Black Oxide
PSLCB	PSLCG		Electroless Nickel Plating
SLCB	SLCG		SUS303

Both Ends Tapped

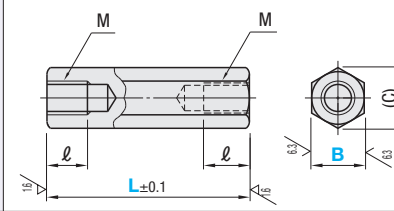

One End Threaded One End Tapped

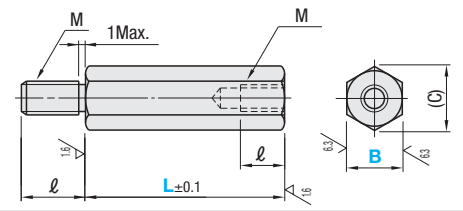

Part Number		L Selection															M	ℓ	(C)
Type	B																		
Both Ends Tapped	*4	5	6	7	8	9	10	15	20	M2	5	4.6							
	*5	5	6	8	9	10	15	20	M2.6	5	5.8								
	5.5	5	6	7	8	9	10	11	12	13	14	15	16	17	18	20	M3	6	6.3

* B Dimensions 4 and 5 are only applicable to SLCB and SLCG. Antirust Oil is applied to posts with black oxide and electroless nickel plating finish.

When L≤Mx6, the Pilot Hole for Both Ends Tapped Type may go through.

For One End Threaded One End Tapped Type, when L dimensions are 5 and 6, then ℓ dimensions are 3 and 4 respectively.

Ordering Example: Part Number - L
 BSLCB 5.5 - 12
 SLCG 5 - 20

Both Ends Tapped

Part Number	Type	B	L	Qty.		
				Unit Price	Volume	Discount Rate
				1-29	30-49	50-100
Steel for general construction or SUM Black Oxide	BSLCB	5.5	5~12			
			13~20			
Steel for general construction or SUM Electroless Nickel Plating	PSLCB	5.5	5~12			
			13~20			
SUS303	SLCB	4	5~10			
			15, 20			
			5~10			
	5.5	5~10				
		15, 20				
		5~12				
			13~20			

For orders larger than indicated quantity, please check with WOS.

One End Threaded One End Tapped

Part Number	Type	B	L	Qty.		
				Unit Price	Volume	Discount Rate
				1-29	30-49	50-100
Steel for general construction or SUM Black Oxide	BSLCG	5.5	5~12			
			13~20			
Steel for general construction or SUM Electroless Nickel Plating	PSLCG	5.5	5~12			
			13~20			
SUS303	SLCG	4	5~10			
			15, 20			
			5~10			
	5.5	5~10				
		15, 20				
		5~12				
			13~20			

For orders larger than indicated quantity, please check with WOS.