

# [High Precision] Lab Jack Horizontal Surface Z-Axis Stages

## High Load Capacity

■ **Features:** Suitable for Z-axis applications requiring long stroke adjustments.

### ■ Lab Jack (Horizontal Surface Z-Axis)



#### ZLJG80

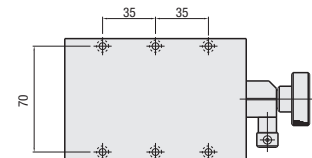
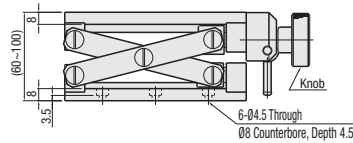
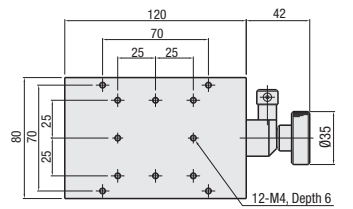

#### ZLJG120

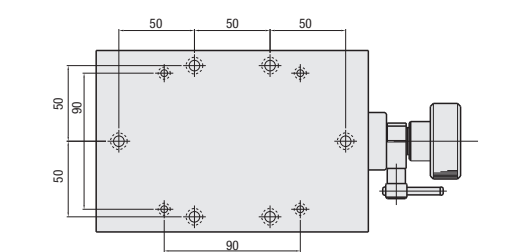
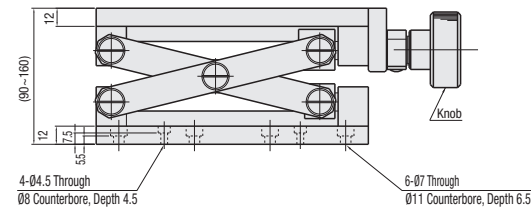
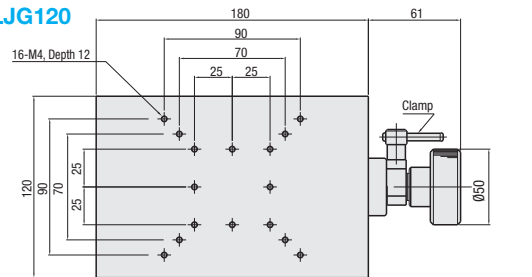

⊕ Knob operated elevating table with relatively high load capacity. A split clamp on the operating shaft securely holds the load in position.

⊙ Clockwise rotation of the knob elevates the stage surface.

Ⓜ Material: Aluminum Alloy

Ⓢ Surface Treatment: Black Anodize

Ⓐ Accessory: Hex Socket Head Cap Screw (Stainless Steel)

ZLJG80: SCB4-10 (6 pcs.)

ZLJG120: SCB4-12, SCB6-12 (4 pcs. each)

| Part Number Type | No. | Stage Surface (mm) | Travel Distance (mm) | Travel per Rotation (mm) | Load Capacity (N) | Parallelism (μm) | Weight (kg) | Unit Price |
|------------------|-----|--------------------|----------------------|--------------------------|-------------------|------------------|-------------|------------|
| ZLJG             | 80  | 80x120             | 40                   | (2)*                     | 68.6              | 200μm            | 1.25        |            |
|                  | 120 | 120x180            | 70                   | (3)*                     | 98.0              |                  | 3.50        |            |

\* The travel distance per knob rotation varies to some extent depending on the current table position.

Ordering Example Part Number ZLJG80

# [Simplified Adjustments] Angle Adjusting Units

■ **Features:** Tight clamping can be achieved by adjusting the rotation direction by the handle and holding the upper and lower surfaces by using screws. Friction effect prevents angle misalignment when clamped.

### ■ Rotary Stages, Simplified Angle Adjusting Units



RoHS 10

### ■ Friction Effect

A plastic washer inserted at the top-and-bottom-plate connecting portion causes appropriate friction, preventing angle misalignment by overtightening of the clamp screw.

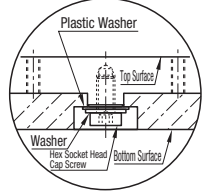

#### XKRC40

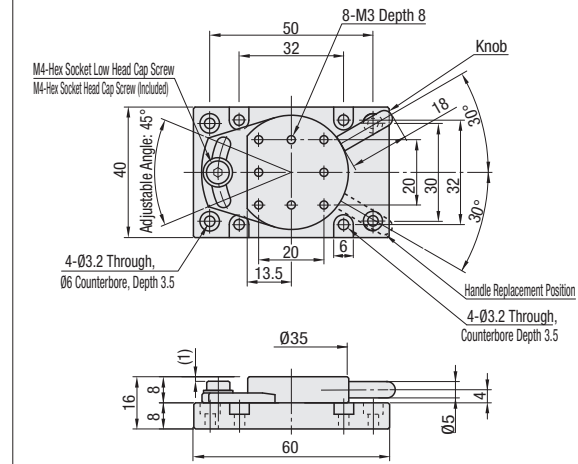

#### XKRC60

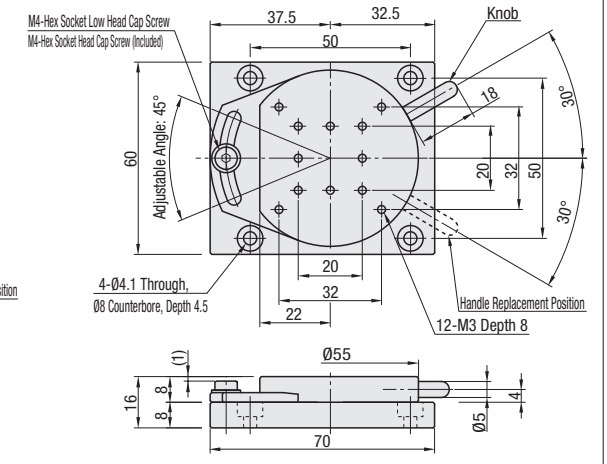

⊕ Top and bottom plates are ground fit, thus the accuracy of the mating plane may change the sliding resistance.

⊙ The adjustment handle is removable, and two handle mounting holes are provided.

⊕ A Hex Socket Head Cap Screw (M4) is included as a clamp bolt enabling clamping by a wrench.

Ⓜ Material: Aluminum Alloy

Ⓢ Surface Treatment: Black Anodize

Ⓐ Accessory: Hex Socket Head Cap Screw RSCB4-10, 1 pc.

| Part Number Type | Stage Surface (mm) | Travel Distance (mm) | Load Capacity (N) Horizontal | Weight (kg) | Unit Price |
|------------------|--------------------|----------------------|------------------------------|-------------|------------|
| XKRC             | 40                 | 035                  | ±22.5°                       | 9.8         | 0.07       |
|                  | 60                 | 055                  |                              | 14.7        | 0.15       |

Ordering Example Part Number XKRC60

### [Combination Examples of Adjustment Units]

| Simplified Adjustment Units | XKRC40 | Page    | XKRC60 | Page |
|-----------------------------|--------|---------|--------|------|
|                             | XKCS30 | 1895    | XKCS30 | 1895 |
| XKDSP40                     | 1964   | XKDSP60 | 1964   |      |
| XKEMA40                     | 1964   | XKEMA60 | 1964   |      |
| XFES40                      | 1896   | XFES60  | 1896   |      |
| XCRS40                      | 1917   | XCRS60  | 1917   |      |
| XZLNG40                     | 1992   | XZLNG60 | 1992   |      |
| ZFES40                      | 1961   | ZFES60  | 1961   |      |
| ZCRS40                      | 1967   | ZCRS60  | 1967   |      |
| ZLFG40                      | 1972   | ZLFG60  | 1972   |      |
| ZLPG40                      | 1973   | ZLPG60  | 1973   |      |
| ZLTG40                      | 1974   | ZLTG60  | 1974   |      |

Example ■ Position Adjustment of Inspection Camera at Painting

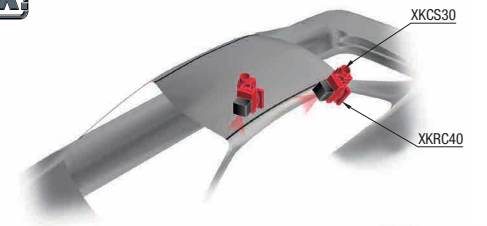

Example

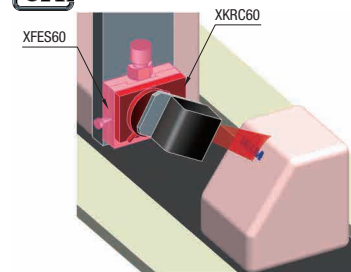

■ Position Adjustment of Print Inspection Instrument

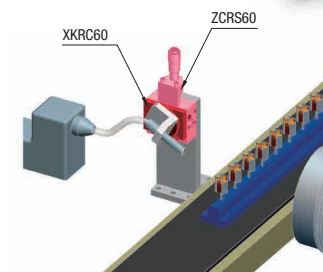

■ Neutralization by Air for Electronic Components

■ Syringe Angle Adjustment

