

# U/T-Shaped Locating Block Sets

# Tapered Pin Locating Block Sets

Standard, Counterbored, Short

■ Features: Uneven shape prevents shifts when mounted.

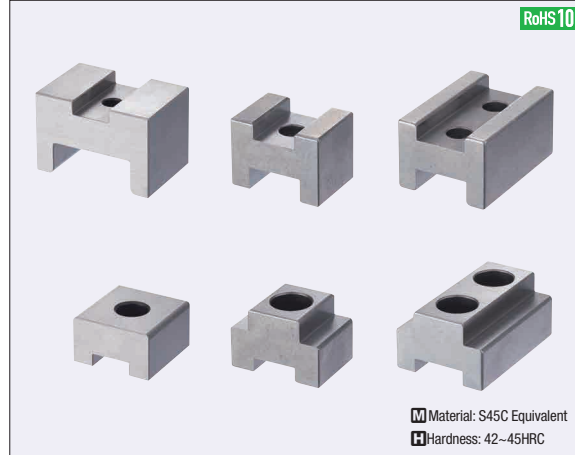

RoHS 10

Material: S45C Equivalent  
Hardness: 42-45HRC

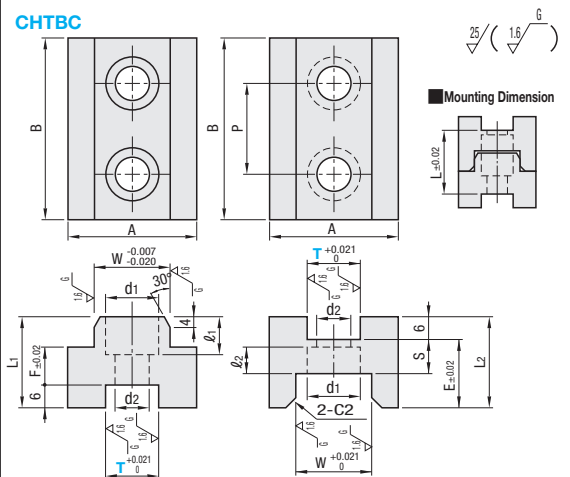
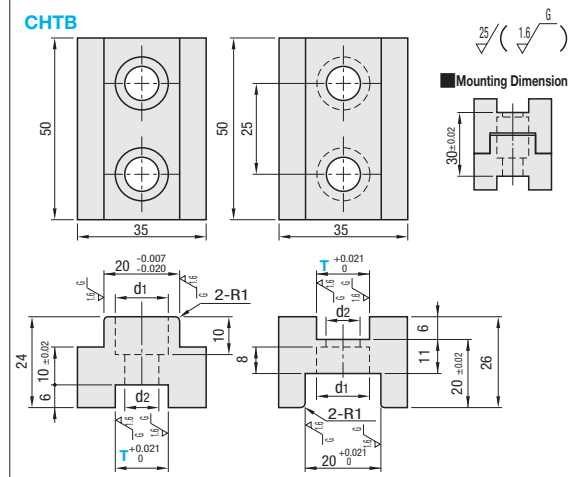
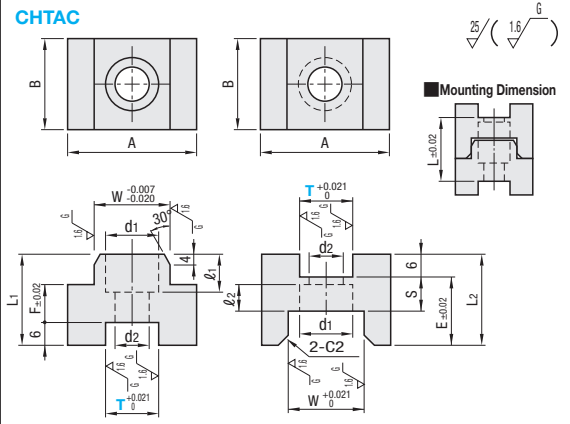
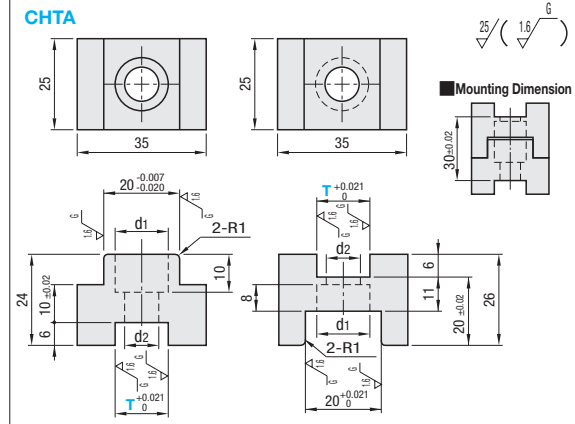
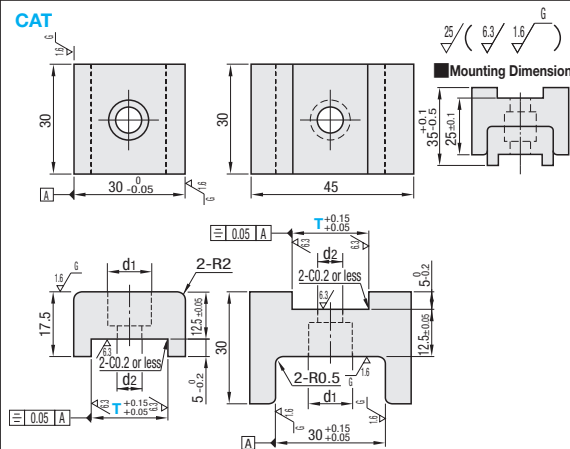

Part Number Type	d1	d2	Unit Price 1-19 set(s)	Volume Discount Rate 20-
CAT	14	11	6.5	
	16	11	6.5	
	20	11	6.5	
CHTA	12	9.5	5.5	
	16	14	9	
	19	14	9	
CHTB	12	9.5	5.5	
	16	14	9	
	19	14	9	

Part Number Type	T	d1	d2	L	A	B	W	L1	ℓ1	F	L2	ℓ2	E	S	P	Unit Price 1-19 set(s)	Volume Discount Rate 20-
CHTAC	12	9.5	5.5	30	35	25	20	24	10	10	26	8	20	11	-		
	16	14	9	30	35	25	20	24	10	10	26	8	20	11	-		
	16L	9.5	5.5	25	30	20	17	21	6.5	7	24	6	18	9	-		
CHTBC	19	14	9	30	35	25	20	24	10	10	26	8	20	11	-		
	16	14	9	30	35	50	20	24	10	10	26	8	20	11	25		
	16L	9.5	5.5	25	30	40	17	21	6.5	7	24	6	18	9	20		
19	14	9	30	35	50	20	24	10	10	26	8	20	11	25			

■ Features: Tapered tip enables smooth insertion and accurate positioning.



RoHS 10

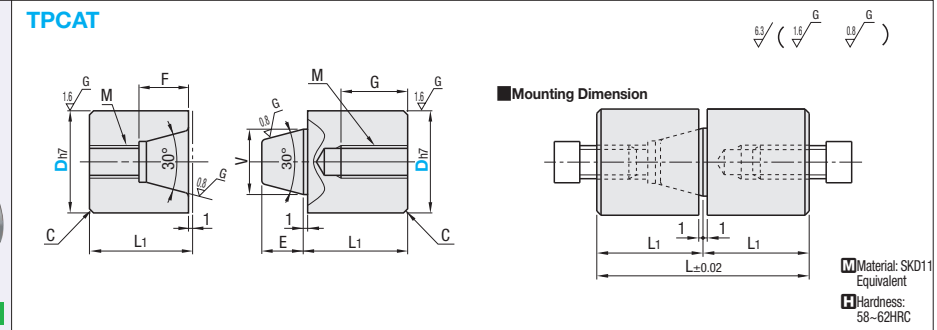

Part Number Type	Dh7	L	L1	F	G	V	E	M	C	Unit Price
TPCAT	12	32	16	7	8	8	5	M4	0.5	
	12C	24	12		5					
	16	32	16		10					
	16C	26	13	7	10	6	M5			
	20	44	22	11	12	12	8	M6		
	20C	36	18	8	8	16	10	M8		
25	50	25	12	16	20	12	M10			
25C	42	21	12	12	12	12				
30	60	30	14	20	20	12				



RoHS 10

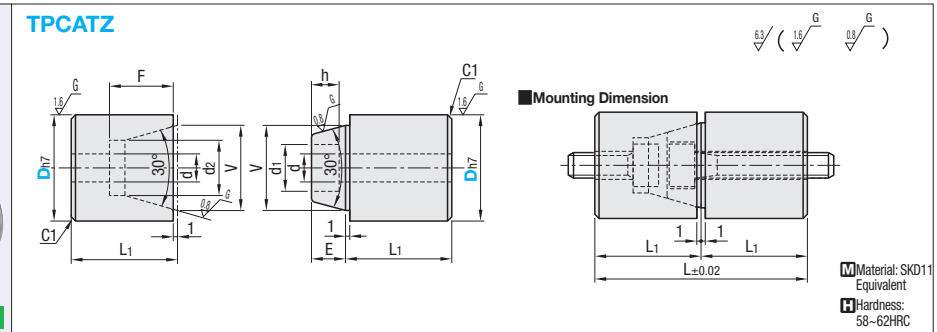

Part Number Type	Dh7	L	L1	F	V	E	d1	d	d2	h	Applicable Screw	Unit Price
TPCATZ	20	44	22	16	16	8	8	4.5	10	5	M4	
	25	50	25	19	20	9	11	6.6	13.5	7	M6	
	30	60	30	23	25	12	14	9	17	9	M8	



RoHS 10

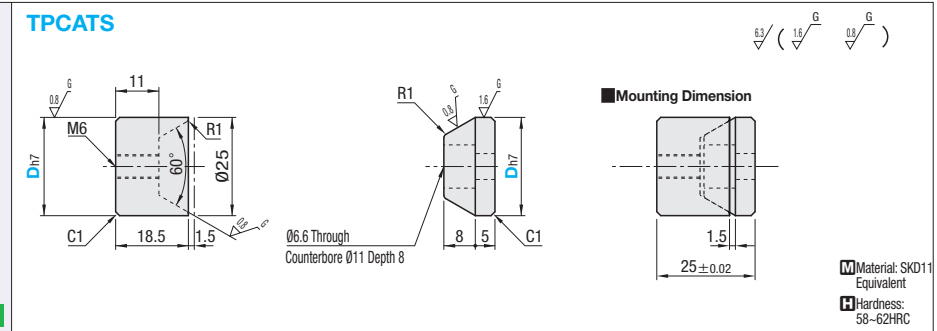

Part Number Type	Dh7	Applicable Screw	Unit Price
TPCATS	25	M6	

Ordering Example  
Part Number  
TPCAT12  
TPCAT25  
TPCATS25

