

# MISUMI C-VALUE Casters

- Medium Load - Wheel Material: Rubber

Comparing points of Similar Products | RoHS: Non-compliant. Running Test Criteria: Company internal standards based on GB (Run distance 1.5km). (Refer to P.2029 for details)

When ordering, select Part Number and Values from Selection Steps 1-3.

Ordering Example: Part Number (1) Type (2) D (3) Wheel Material  
**C-CTCJ75 - R**

## Swivel Type



Type	Main Body		Wheel		Bearing	
	M Material	S Surface Treatment	M Material (Color)	Swiveling Part	Wheel	
C-CTCJ	SPCC	Zinc Plating	Rubber (Black)	Incorporated	Incorporated	

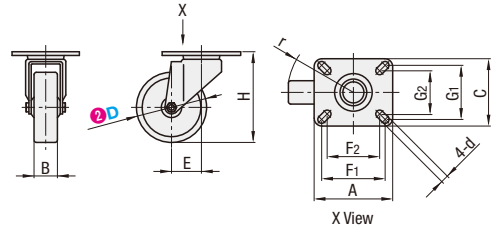

Part Number		Wheel Material	H	A	C	F1	F2	G1	G2	d	B	E	r	Allowable Load (N)	Mass (g)
1 Type	2 D														
C-CTCJ	75	R (Rubber)	97	84	72	64.3	59.3	54	50	8.5	25	32.5	70	700	485
	100		128	105	85	82.5	70	62.5		9	30	38.5	90	1000	900
	125		153	135	105	110	100	85	75	10	37.5	42	107.5	1200	1250
	150		187	140	110	100	85	75	10	40	68.5	143	1600	2350	

## Fixed Type



Type	Main Body		Wheel		Bearing	
	M Material	S Surface Treatment	M Material (Color)	Swiveling Part	Wheel	
C-CTCK	SPCC	Zinc Plating	Rubber (Black)	None	Incorporated	

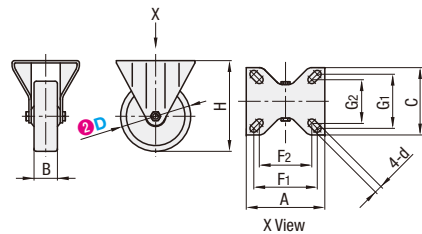

Part Number		Wheel Material	H	A	C	F1	F2	G1	G2	d	B	E	r	Allowable Load (N)	Mass (g)
1 Type	2 D														
C-CTCK	75	R (Rubber)	97	84	72	64.3	59.3	54	50	8.5	25	32.5	70	700	399
	100		128	105	85	82.5	70	62.5		9	30	38.5	90	1000	714
	125		153	140	110	110	100	85	75	10	37.5	42	107.5	1200	1033
	150		187	140	110	100	85	75	10	40	68.5	143	1600	1865	

## Swivel Type + Stopper



Type	Main Body		Wheel		Bearing	
	M Material	S Surface Treatment	M Material (Color)	Swiveling Part	Wheel	
C-CTCS	SPCC	Zinc Plating	Rubber (Black)	Incorporated	Incorporated	

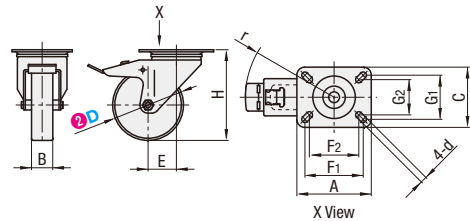

Part Number		Wheel Material	H	A	C	F1	F2	G1	G2	d	B	E	r	Allowable Load (N)	Mass (g)
1 Type	2 D														
C-CTCS	75	R (Rubber)	97	84	72	64.3	59.3	54	50	8.5	25	32.5	93	700	563
	100		128	105	85	82.5	70	62.5		9	30	39.5	125	1000	1120
	125		153	135	105	110	100	85	75	10	37.5	44.5	127	1200	1424
	150		187	140	110	100	85	75	10	40	68.5	184	1600	2524	

# MISUMI C-VALUE Casters

- Medium Load - Wheel Material: Urethane

Comparing points of Similar Products | RoHS: Non-compliant. Running Test Criteria: Company internal standards based on GB (Run distance 1.5km). (Refer to P.2029 for details)

When ordering, select Part Number and Values from Selection Steps 1-3.

Ordering Example: Part Number (1) Type (2) D (3) Wheel Material  
**C-CSDJ80 - U**

## Swivel Type



Type	Main Body		Wheel		Bearing	
	M Material	S Surface Treatment	M Material (Color)	Swiveling Part	Wheel	
C-CSDJ	SUS304 Equivalent	-	Urethane (Red)	Incorporated	Incorporated	

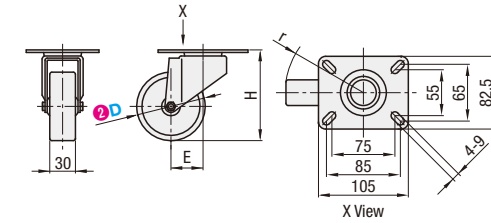

Part Number		Wheel Material	H	E	r	Allowable Load (N)	Mass (g)
1 Type	2 D						
C-CSDJ	80	U (Urethane)	106	37.8	77.5	1000	627
	100		128	38.5	90	1200	800

## Fixed Type



Type	Main Body		Wheel		Bearing	
	M Material	S Surface Treatment	M Material (Color)	Swiveling Part	Wheel	
C-CSDK	SUS304 Equivalent	-	Urethane (Red)	None	Incorporated	

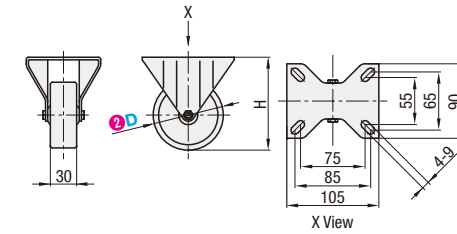

Part Number		Wheel Material	H	Allowable Load (N)	Mass (g)
1 Type	2 D				
C-CSDK	80	U (Urethane)	106	1000	391
	100		106	1200	391

## Swivel Type + Stopper



Type	Main Body		Wheel		Bearing	
	M Material	S Surface Treatment	M Material (Color)	Swiveling Part	Wheel	
C-CSDS	SUS304 Equivalent	-	Urethane (Red)	Incorporated	Incorporated	

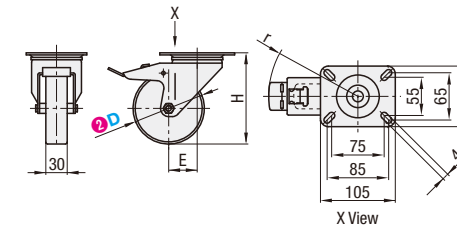

Part Number		Wheel Material	H	E	r	Allowable Load (N)	Mass (g)
1 Type	2 D						
C-CSDS	80	U (Urethane)	106	40	125	1000	776
	100		128	39.5	125	1200	900